

Processing Urine Samples with BD Vacutainer™ Collection Products

UA Preservative or Plain UA Tube and Culture & Sensitivity (C&S) Preservative Tube

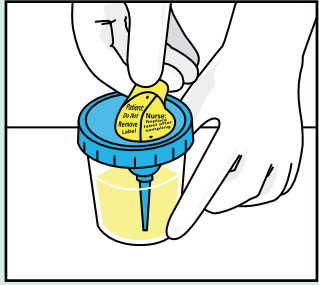

1. Peel back protective sticker to expose rubber-covered cannula.

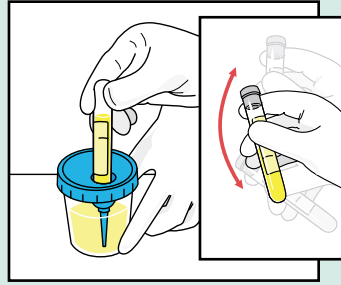

2.
 - Push C&S Preservative Tube (gray top) into the integrated transfer port.
 - Hold in position until flow stops.
 - Remove tube.
 - Shake tube vigorously.

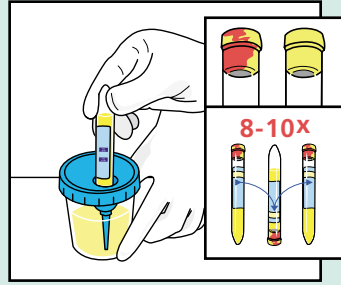

3.
 - Push UA Preservative Tube (cherry red/yellow top) or plain UA Tube (yellow top) into integrated transfer port.
 - Hold in position until flow stops.
 - Remove tube.
 - Invert UA Preservative Tube 8-10 times to mix the sample.

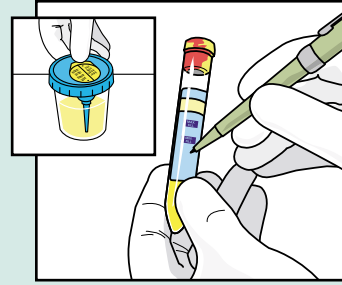

4.
 - Place protective sticker back over the integrated transfer port.
 - Label both filled tubes with patient's name, the date/time of specimen collection and any other data required by your institution.

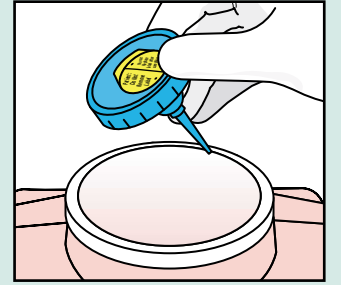

5.
 - Remove lid from cup and dispose in a sharps collector.
 - Dispose of urine according to your facility's policy.
 - Dispose of collection cup as a biohazard.

UA Preservative or Plain UA Tube Only

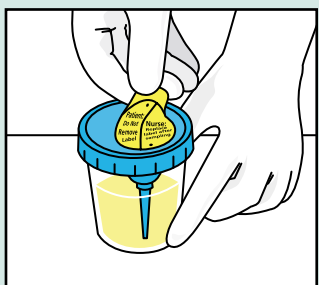

1. Peel back protective sticker to expose rubber-covered cannula.

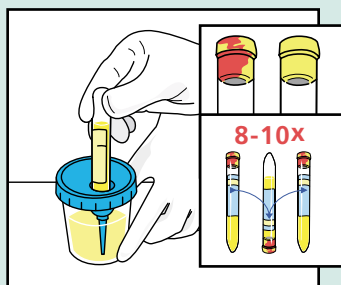

2.
 - Push UA Preservative Tube (cherry red/yellow top) or plain UA Tube (yellow top) into integrated transfer port.
 - Hold in position until flow stops.
 - Remove tube.
 - Invert UA Preservative Tube 8-10 times to mix the sample.

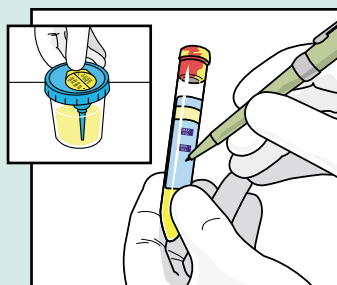

3.
 - Place protective sticker back over the integrated transfer port.
 - Label filled tube with patient's name, the date/time of specimen collection and any other data required by your institution.

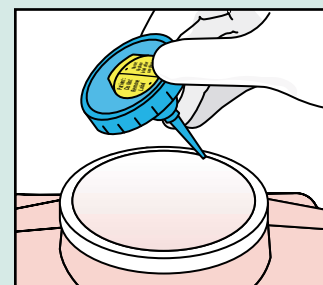

5.
 - Remove lid from cup and dispose in a sharps collector.
 - Dispose of urine according to your facility's policy.
 - Dispose of collection cup as a biohazard.

C&S Preservative Tube Only

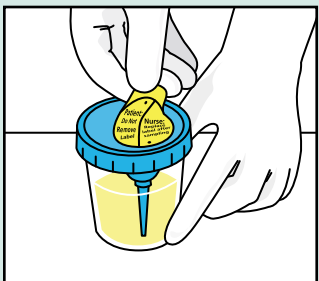

1. Peel back protective sticker to expose rubber-covered cannula.

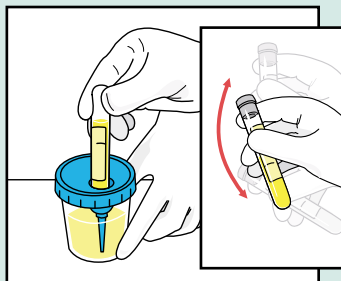

2.
 - Push C&S Preservative Tube (gray top) into the integrated transfer port.
 - Hold in position until flow stops.
 - Remove tube.
 - Shake tube vigorously.

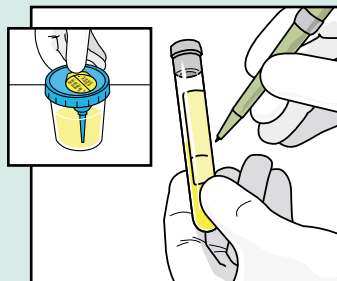

3.
 - Place protective sticker back over the integrated transfer port.
 - Label filled tube with patient's name, the date/time of specimen collection and any other data required by your institution.

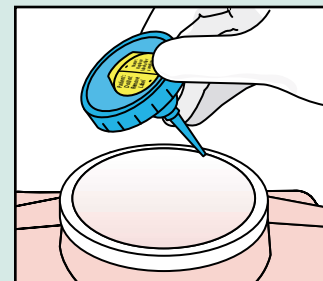

5.
 - Remove lid from cup and dispose in a sharps collector.
 - Dispose of urine according to your facility's policy.
 - Dispose of collection cup as a biohazard.

BD Vacutainer Technical Services: 1.800.631.0174

BD Customer Service: 1.888.237.2762

Handle all biologic samples and medical "sharps" (lancets, needles and transfer straws) according to the policies and procedures of your facility. Obtain appropriate medical attention in the event of any exposure to biologic samples (for example, through a puncture injury) since they may transmit viral hepatitis, HIV (AIDS), or other infectious diseases. BD does not recommend resheathing used needles, but the policies and procedures of your facility may differ and must always be followed. Discard any medical "sharps" in biohazard containers approved for their disposal.



**BD Vacutainer Systems
Preanalytical Solutions**

1 Becton Drive
Franklin Lakes, NJ 07417

www.bd.com/vacutainer

Processing Urine Samples with BD Vacutainer® Collection Products

UA Preservative or Plain UA Tube with Culture and Sensitivity (C&S) Tube

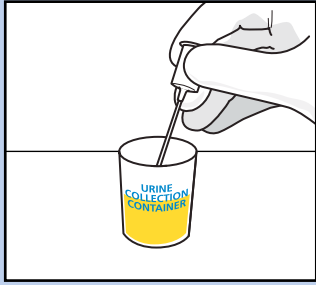

1. Submerge tip of transfer straw in specimen.

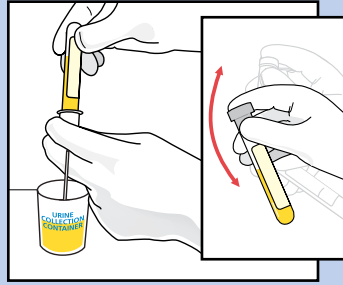

2. • Push C&S Preservative Tube (gray top) into the transfer straw.
 - Hold in position until flow stops.
 - Remove tube, leaving transfer straw in specimen container.
 - Shake tube vigorously.

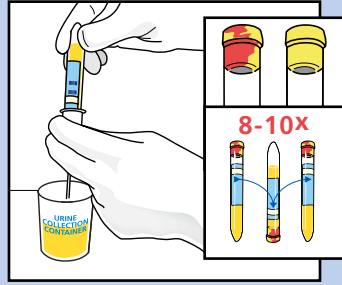

3. • Push UA Preservative Tube (cherry red/yellow top) or plain UA Tube (yellow top) into transfer straw completely.
 - Hold in position until flow stops.
 - Remove tube, leaving transfer straw in specimen container.
 - Invert UA Preservative Tube 8-10 times to mix the sample.

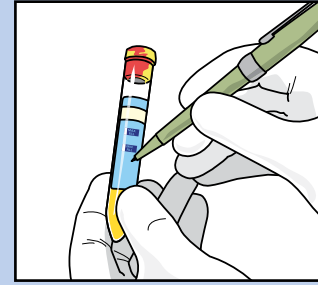

4. Label both filled tubes with patient's name, the date/time of specimen collection and any other data required by your institution.

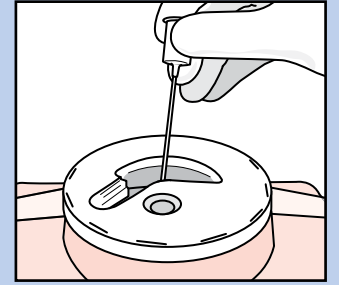

5. Dispose of transfer straw in sharps collector.

UA Preservative or Plain UA Tube Only

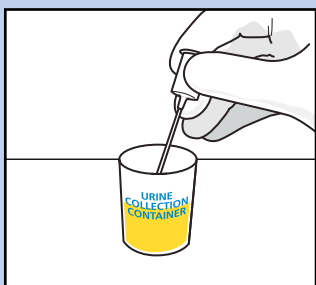

1. Submerge tip of transfer straw in specimen.

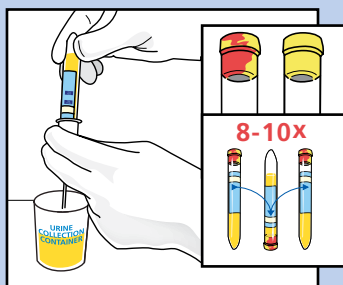

2. • Push UA Preservative Tube (cherry red/yellow top) or plain UA Tube (yellow top) into transfer straw completely.
 - Hold in position until flow stops.
 - Remove tube, leaving transfer straw in specimen container.
 - Invert UA Preservative Tube 8-10 times to mix the sample.

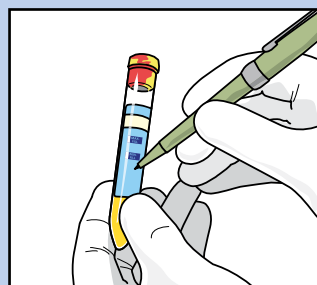

3. Label filled tube with patient's name, the date/time of specimen collection and any other data required by your institution.

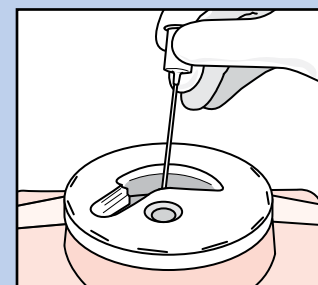

4. Dispose of transfer straw in sharps collector.

C&S Tube Only



1. Submerge tip of transfer straw in specimen.

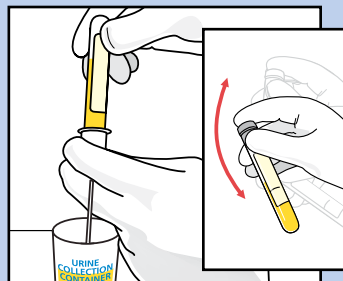

2. • Push C&S Preservative Tube (gray top) into the transfer straw all the way.
 - Hold in position until flow stops.
 - Remove tube, leaving transfer straw in specimen container.
 - Shake tube vigorously.

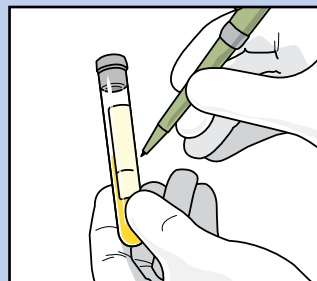

3. Label filled tube with patient's name, the date/time of specimen collection and any other data required by your institution.

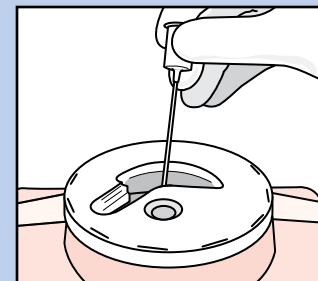

4. Dispose of transfer straw in sharps collector.

BD Global Technical Services: 1.800.631.0174
vacutainer_techservices@bd.com
BD Customer Service: 1.888.237.2762
www.bd.com/vacutainer

Handle all biologic samples and medical "sharps" (lancets, needles, and transfer straws) according to the policies and procedures of your facility. Obtain appropriate medical attention in the event of any exposure to biologic samples (for example, through a puncture injury) since they may transmit viral hepatitis, HIV (AIDS), or other infectious diseases. BD does not recommend resheathing used needles, but the policies and procedures of your facility may differ and must always be followed. Discard any medical "sharps" in biohazard containers approved for their disposal.



BD Diagnostics
Preanalytical Systems
1 Becton Drive
Franklin Lakes, NJ 07417