

Patient information- Throat Self-Swab for Strep A testing

(LAB7907 – Group A Streptococcus PCR or LAB4171 Upper Respiratory Culture)

1. Wash your hands with soap and water.
2. Open the packet and remove the swab. Don't touch the soft tip of the swab with your hands or other surfaces.
3. Open your mouth as wide as you can, take a deep breath and hold it.
4. Trying not to touch your tongue, put the swab to the very back of your throat. (It's okay if you accidentally touch your tongue) Rub the tip firmly and quickly from one side of your throat to the other and back. It's okay if you gag. Saying 'aaahh' gets your tongue out of the way and helps you reach all the way to the back.
5. Remove the swab from your mouth and carefully put it into the screw top tube. Snap off the swab at the scored area (weak point halfway down the swab). Do not break the swab at any other place.
6. Discard the broken part of the swab. Make sure the ESWAB lid is screwed on tight so it does not leak.
7. Label the tube with your full name, date of birth, date, time of collection and swab site (throat).
8. Wash your hands and return labelled tube in the biohazard bag provided to the laboratory.



1 Remove the swab from its packaging, holding by the end of the applicator and identify the breaking point.

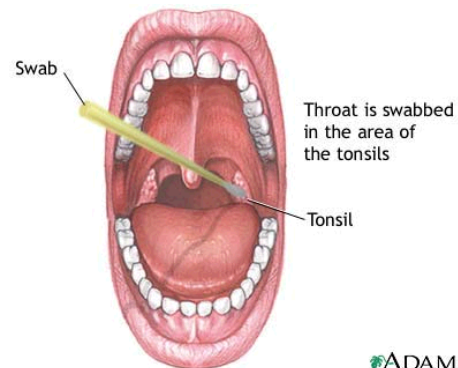

ADAM.

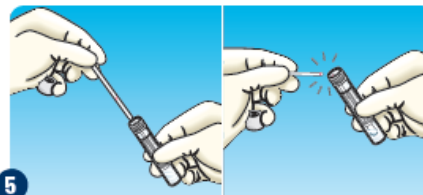

5 While holding the swab, remove the cap from the tube.

- Insert the swab into the tube until the breakpoint is level with the tube opening.
- Bend the swab shaft at a 180 degrees angle to break it off at the breaking point. You may need to gently rotate the swab shaft to complete the breakage.

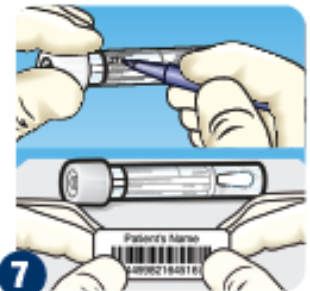

7 Screw the cap back onto the tube and apply patient identification label or write patient information on the tube label.



Wash hands with soap and water.

Medical Directors, TriHealth Laboratories

Sajini Mathew MD—Bethesda North Hospital, Good Samaritan Hospital, TriHealth Anderson, Good Samaritan Western Ridge, TriHealth Kenwood

Megan Smith MD—Bethesda Arrow Springs, Bethesda Butler Hospital, McCullough Hyde Memorial Hospital

Patient information- Throat Self-Swab for Strep A testing (Spanish)

Información del Paciente - Auto-Toma de Muestra de Garganta para Prueba de Strep A

(LAB7907 – PCR de Streptococcus del Grupo A o LAB4171 Cultivo de Vías Respiratorias Superiores)

1. Lávese las manos con agua y jabón.
2. Abra el paquete y retire el hisopo. No toque la punta suave del hisopo con las manos u otras superficies.
3. Abra la boca lo más que pueda, tome una respiración profunda y manténgala.
4. Intentando no tocar la lengua, coloque el hisopo en la parte más profunda de la garganta. (Está bien si accidentalmente toca la lengua). Frote la punta firmemente y rápidamente de un lado de la garganta al otro y de regreso. Es normal si siente náuseas. Decir "aaahh" ayuda a que la lengua se aleje y facilita llegar hasta la parte más profunda.
5. Retire el hisopo de la boca y colóquelo cuidadosamente en el tubo con tapa de rosca. Rompa el hisopo en la zona marcada (punto débil a mitad del hisopo). No rompa el hisopo en ninguna otra parte.
6. Deseche la parte rota del hisopo. Asegúrese de que la tapa del ESWAB esté bien ajustada para que no haya fugas.
7. Etiquete el tubo con su nombre completo, fecha de nacimiento, fecha, hora de recolección y lugar de toma de muestra (garganta).
8. Lávese las manos y devuelva el tubo etiquetado en la bolsa de bioseguridad proporcionada al laboratorio.



hisopo

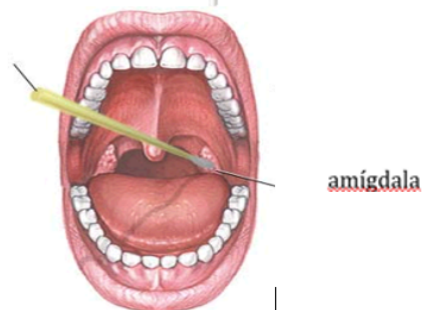

amígdala



Medical Directors, TriHealth Laboratories

Sajini Mathew MD—Bethesda North Hospital, Good Samaritan Hospital, TriHealth Anderson, Good Samaritan Western Ridge, TriHealth Kenwood
Megan Smith MD—Bethesda Arrow Springs, Bethesda Butler Hospital, McCullough Hyde Memorial Hospital



Medical Directors, TriHealth Laboratories

Sajini Mathew MD—Bethesda North Hospital, Good Samaritan Hospital, TriHealth Anderson, Good Samaritan Western Ridge, TriHealth Kenwood
Megan Smith MD—Bethesda Arrow Springs, Bethesda Butler Hospital, McCullough Hyde Memorial Hospital